

Conduit Fittings- Chase Nipple



Features

Conduit chase nipples are used along with rigid couplings to terminate a run of threaded conduit into an enclosure box. This zinc die cast chase nipple is rated for both indoor and outdoor use.



Sizing and Features

Product	Size	Description	Qty	Sizes	
				A	B
G-CN050	1/2"	Standard	100	.68	1.02
G-CN075	3/4"	Standard	50	1.00	1.29
G-CN100	1"	Standard	25	.87	1.53
G-CN125	1-1/4"	Standard	25	.94	1.89
G-CN150	1-1/2"	Standard	25	.91	2.30
G-CN200	2"	Standard	10	1.07	2.88
G-CN250	2-1/2"	Standard	10	1.38	3.39
G-CN300	3"	Standard	10	1.44	4.06
G-CN350	3-1/2"	Standard	10	1.47	4.61
G-CN400	4"	Standard	5	1.47	5.15

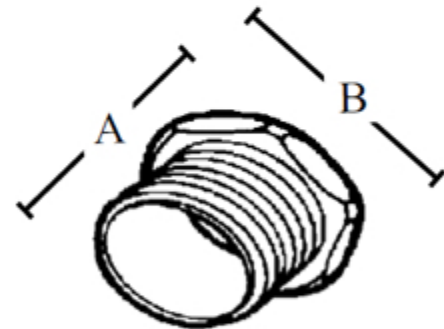

- Zinc Die Cast
- Corrosion Resistant
- Use with locknuts
- Serves as a short raceway between electrical enclosures

